

SENSO S-Smartphone sensor

Datasheet

Controls

- 1 – Optical light sensor
- 2 – 3.5 mm jack plug

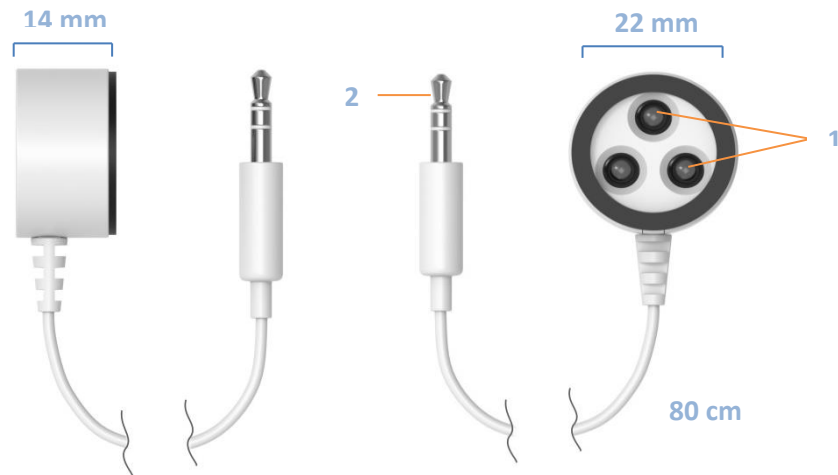

How it works

SENSO S-Smartphone sensor is specially designed for SENSO alerting system. It catches light signals (incoming calls, messages) from a screen of a mobile phone and transmits them to connected SENSO device. The sensor is placed on the mobile phone and is activated when display lights up. SENSO S-Smartphone sensor can be connected to SENSO Signal transmitter, SENSO Baby transmitter, SENSO Sound receiver, SENSO Light receiver and SENSO Charger for Compact receiver.

Size and weight

Height: 14 mm / 0.55 inch
Diameter: 22 mm / 0.87 inch
Cable length: 80 mm / 3.15 inch
Weight: 8 g / 0.28 oz.

In the box

SENSO S-Smartphone sensor
User manual

General data

Specifications:

- Material: ABS plastic
- Light sensitivity: visible light > 3 lux for longer than 2 s
- Connector: 3.5 mm stereo jack
- Sensor type: optical
- Intrusion and water protection: IP20

Environmental requirements:

- Temperature: from 0°C to +40°C
- Relative humidity: from 5% to 95%

